

# FK-31 Series:

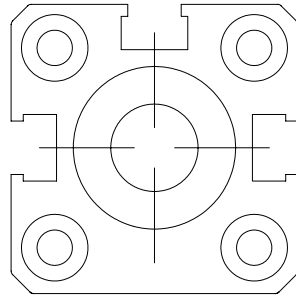

Groove:

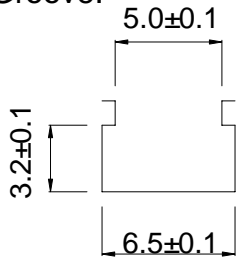

Unit : mm

## Specification

| Characteristics \ Type | FK - 31R  | FK - 31N   | FK - 31P        |
|------------------------|---|--|-----------------|
| Wiring                 | 2Wire   | 3 Wire   |                 |
| Connect Diagram        |   |  |                 |
| Switching logic        | Normally open                                     | Solid state output, Normally open                  |                 |
| Output                 | Reed switch                                       | NPN Sinking  | PNP Sourcing    |
| Lead wire type         | Horizontal  |  |                 |
| Load voltage           | 5 ~ 240V DC/AC                                    | 5~28V DC   |                 |
| Load current           | 100mA Max.  | 200mA Max.   |                 |
| Switching rating       | 10W Max.  | 6W Max.  |                 |
| Current consumption    | ---   | 19mA Max. @ 24V                                    | 16mA Max. @ 24V |
| Voltage drop           | 2.5V Max. @ 100mA DC                              | 1.5V Max. @ 200mA (Resistive load)                 |                 |
| Leakage current        | ---   | 0.01mA Max.  |                 |
| Frequency              | 200Hz   | 1000Hz   |                 |
| Shock                  | 30G   | 50G  |                 |
| Vibration              | 90 m/s <sup>2</sup> (9G), Double amplitude 1.5 mm |  |                 |
| Insulation resistant   | DC 500V 100MΩ (Lead wire to case)                 |  |                 |
| Withstand voltage      | AC 1000V (50/60Hz) 1 minute (Lead wire to case)   |  |                 |
| CE & Protection IP     | EN60947-5-2 IEC529 IP67(NEMA 6)                   |  |                 |
| Indicator              | Red LED   | Red LED  | Green LED       |
| Cable                  | 2.8 φ ,2C, Gray PVC                               | 2.8 φ ,3C, Black PVC                               |                 |
| Temperature range      | -10 ~ 70°C  |  |                 |
| Protection circuit     | ---   | Reverse polarity; Surge suppression, Short circuit |                 |
| Dimensions             |   |  |                 |

